

# HVS PRO PORTABLE HOUSING UNITS



# HVS PRO PORTABLE HOUSING UNITS



The HVS Pro® is a pre-fabricated foldable structure that is rapidly deployable, expandable, and can be easily stacked for economical shipping and storage. The HVS Pro® Housing Variable System is suitable for a wide range of applications to include hospitals, clinics, military barracks, hunting shelters, site offices and emergency relief housing. All the modules are insulated and sealed to protect and withstand extreme weather conditions in all types of terrains.

SPECIFICATION	HVS PRO® MODULES
Economical Shipment & Storage	Cost of sea freight shipment and storage reduced from 50% up to 65% due to foldable system.
Expands for useable space and can be returned to original dimensions when disassembled	The HVS Pro® Modular Systems are easily folded and unfolded by a minimum of 4 unskilled personnel in less than 40 minutes.
Suitable to address infrastructure needs	The basic system is pre-cabled for electricity, water supply, and waste water; medical gas is optional.
Sturdy enough for multiple reuse	The life expectancy is certified for more than 20 years.
Designed for compliance with Americans with Disabilities Act and all other applicable Federal, State, and local legislation	Modules can be pre-built and assembled according to any specific requirements.
Minimum 700 useable square feet	One HVS Pro® Model 60H27 offers 442 square feet. These modules can be interlocked to form a wide range of useable square footage.
Modular in design	Two or more modules can be coupled together to form an integrated system of functional spaces and can also be adapted to integrate together with other traditional systems of pre-fabricated or traditional structures
Minimum 1 door and 1 window	Each module comes equipped with an external and interior door and a standard sliding or optional swing type window.
Minimal site work to erect	Modules do not require site preparation such as infrastructure or concrete foundations and are equipped with mechanical jacks which allows for the horizontal positioning of the modules in case of irregular and unevenness of the terrain.
Transported by tractor/trailer	Several units can be folded and loaded on 20ft & 40ft trailers (depending on the model).
Useable in all regions during any season	All modules are insulated and sealed to protect and withstand intense heat, rain, sleet, snow, sandstorms, and wind and are protected against atmospheric discharges such as thunder and lightning.

# HVS PRO PORTABLE HOUSING UNITS



This prefabrication sector deals with a containerized structures, motorized and modular, with standard dimensions and to specific customer requirements. This is an example of the inside of a office requirement

# HVS PRO PORTABLE HOUSING UNITS

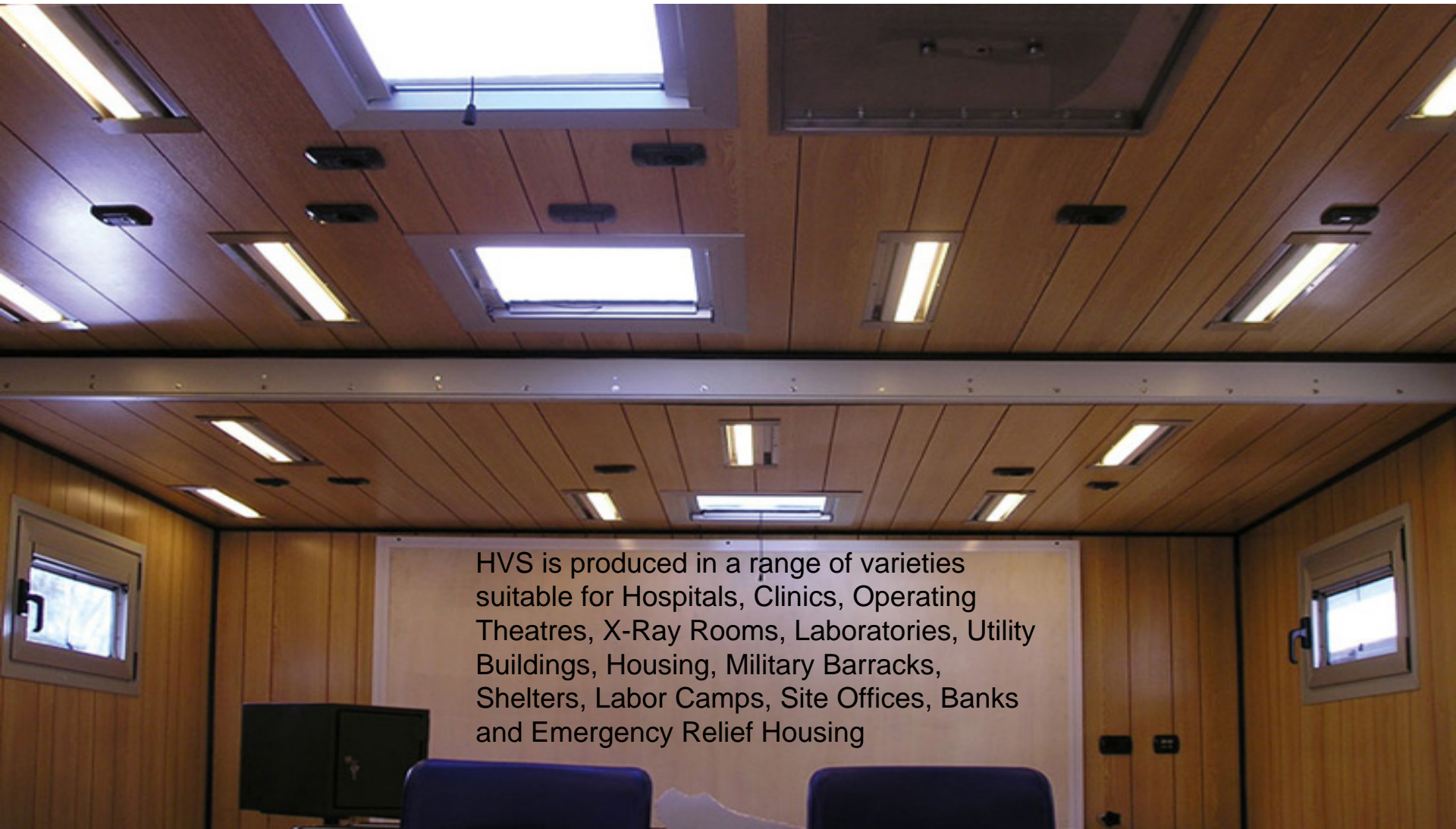

HVS is produced in a range of varieties suitable for Hospitals, Clinics, Operating Theatres, X-Ray Rooms, Laboratories, Utility Buildings, Housing, Military Barracks, Shelters, Labor Camps, Site Offices, Banks and Emergency Relief Housing

# Bullet Proof Module



All modules come with ballistics and Non-ballistic capabilities tested to within 5.56 up to 7.62 mm rounds

# PORTABLE MEDICAL FACILITIES

parameters such as; static and mechanical capacities, operative temperatures, heavy atmospheric conditions and others that a customer may wish us to incorporate and the modules can be manufactured from different materials, such as; steel or aluminium structures and fire rated panels in organic/inorganic materials, with or without thermal or acoustic isolation in polyurethane. All the HVS Pro® Modules can be coupled to become an integrated system of functional spaces.



X-Ray Room Module



Laboratory Module

## The HVS Pro® GENERAL FEATURES

The HVS Pro® modules come suitable for containerization and they are delivered with the base floor and walls and roof panels and are insulated with the appropriate polyurethane to support the design loadings and the internal section have insulated wall panels, door and window panels and finishing profiles. It would take 4 unskilled personnel less than 30 minutes to unload and unfold the module and a further 15 minutes to hook up to pre positioned mobile services, such as water, electric and waste.



Radiological Room Module

# HVS Medical units

- Our design team make the necessary research to ensure equipment selected by the customer is suitable for fixing and transportation, we fix and install equipment for hospital, laboratories, clinics, operating theaters, X- ray rooms. examination rooms, office, kitchens, bathrooms with showers washbasins, bathtubs, and knock down bedroom furniture
- The modules come fully operative and ready to use operating theater, with operating table, surgical room furniture, surgical lamps and medical monitoring systems. All electrical , electronic equipment services and medical gas lines built into perimeter walls and ceiling.





KTCOK LLC is Pleased to provide a broad range of services, expanding them as needed to suit our customers' needs. Our resourcefulness and vast network of suppliers, backed with historical knowledge of the industry and quality service will provide you all the expertise needed to assist you with any project.

We manage a small successful organization developed and operated by previous contractors across the board and one myself a veteran of Desert Storm, Iraqi Freedom, 2 year deployment to Kosovo, Bosnia and Somalia. We have several other veterans involved in the company. This broad range of expertise give us great insight on many of your requirements. Our company's hard work and dedication and perhaps most importantly, these are the personnel which would develop a though understanding of your service requirements. We manage all projects in a manner that is predicated on ensuring quality, efficiency and overall costumer scarification.

We have developed standards consistent with the international market. We have set forth the policies, process and procedures that guide our company into a costumer-centered organization. We are committed to providing our costumers with a quality product at every moment of performance with emphasis on safety and security.

Please feel free to contact me at any time day or Night



# Contact Information

Ron Foster  
CEO  
6420 South General Bruce Drive  
Temple, TX 76504  
(254) 933-8470  
[ronfoster@ktcok.com](mailto:ronfoster@ktcok.com)

Phil Marley  
Executive VP  
6420 South General Bruce Drive  
Temple, TX 76504  
(254) 933-8470  
[philmarley@ktcok.com](mailto:philmarley@ktcok.com)

OPEN SIDE VIEW

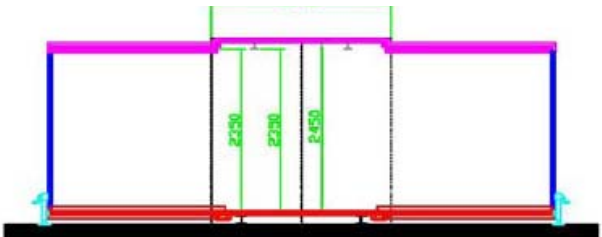

OPEN TOP VIEW

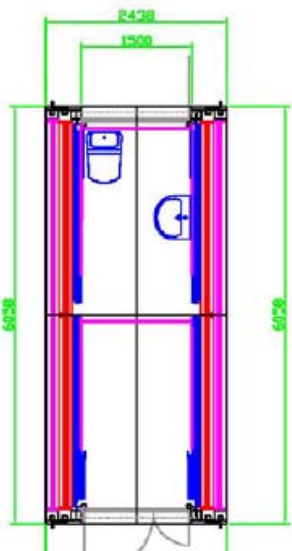
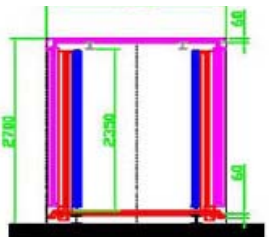
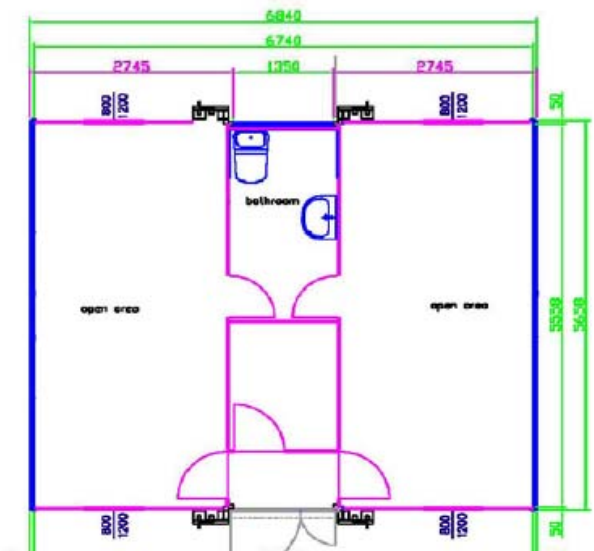

CLOSED SIDE VIEW

CLOSED TOP VIEW